

Ye Olde Mill Campground

8277 State Highway 73

Townsend, Tennessee 37882

(865) 448-6681

Camping Rates

(Rates are Based on Four Person Occupancy)

	<u>DAILY</u>	<u>MONTHLY</u>
River lots – full service	34.00	20 % off
Off river with patio – full service	31.00	20 % off
Primitive sites (tents only)	22.00	
Extra adults	2.00	
Extra children 7-17 years	2.00	
Children 6 and under	N/C	
Visitors – children/adults	2.00	

10 % discount for Senior Citizens 65 years and over, and/or stays of 7 days.

Reservations recommended. We require a one night deposit, which is refundable only with a 10 day notice. Refunds will be charged a \$5.00 administration fee.

The above prices are subject to sales tax and hotel – motel – campground tax.

**LOOKING FORWARD TO
SEEING YOU IN TOWNSEND**

CABLE TV CHANNEL LINE-UP

- | | |
|----------------------|--------------------------|
| 2 WETP-PBS | 36 GAC |
| 3 WPXK | 37 FOX NEWS |
| 4 WMAK | 38 FOOD NETWORK |
| 5 WVLT-CBS | 39 TRU-TV |
| 6 QVC | 40 TRINITY BROADCASTING |
| 7 WBXX-CW | 41 SCI-FI |
| 8 WVLT-MTVN | 42 HSN |
| 9 WBIR-NBC | 43 BET |
| 10 LOCAL PROGRAMMING | 44 TV GUIDE NETWORK |
| 11 WTNZ-FOX | 45 TURNER CLASSIC MOVIES |
| 12 COMMUNITY TV | 46 FX |
| 13 WATE-ABC | 47 GOLF CHANNEL |
| 14 WGN-CHICAGO | 48 LEARNING CHANNEL |
| 15 WVLR-CTN | 49 CARTOON NETWORK |
| 16 ABC FAMILY | 50 CNBC |
| 17 LIFETIME | 51 DISCOVERY HEALTH |
| 18 WEATHER CHANNEL | 52 SPEED CHANNEL |
| 19 FOX SPORTS SOUTH | 53 VERSUS |
| 20 MTV | 54 BRAVO |
| 21 10NEWS 2 | 55 DIY NETWORK |
| 22 CNN | 56 STYLE |
| 23 CNN HEADLINE NEWS | 57 G4 |
| 24 VH-1 | 58 SPORTSOUTH |
| 25 HISTORY CHANNEL | 59 HALLMARK CHANNEL |
| 26 COMEDY CENTRAL | 60 DISNEY |
| 27 NICKELODEON | 61 TRAVEL CHANNEL |
| 28 HGTV | 66 DISCOVERY CHANNEL |
| 29 A & E | 67 TNT |
| 30 USA NETWORK | 68 ANIMAL PLANET |
| 31 ESPN2 | 69 SPIKE TV |
| 32 ESPN | 70 AMC |
| 33 COMCAST SPORTS SE | 71 TV LAND |
| 34 TBS | 98 C-SPAN. |
| 35 EI ENTERTAINMENT | |

Little River

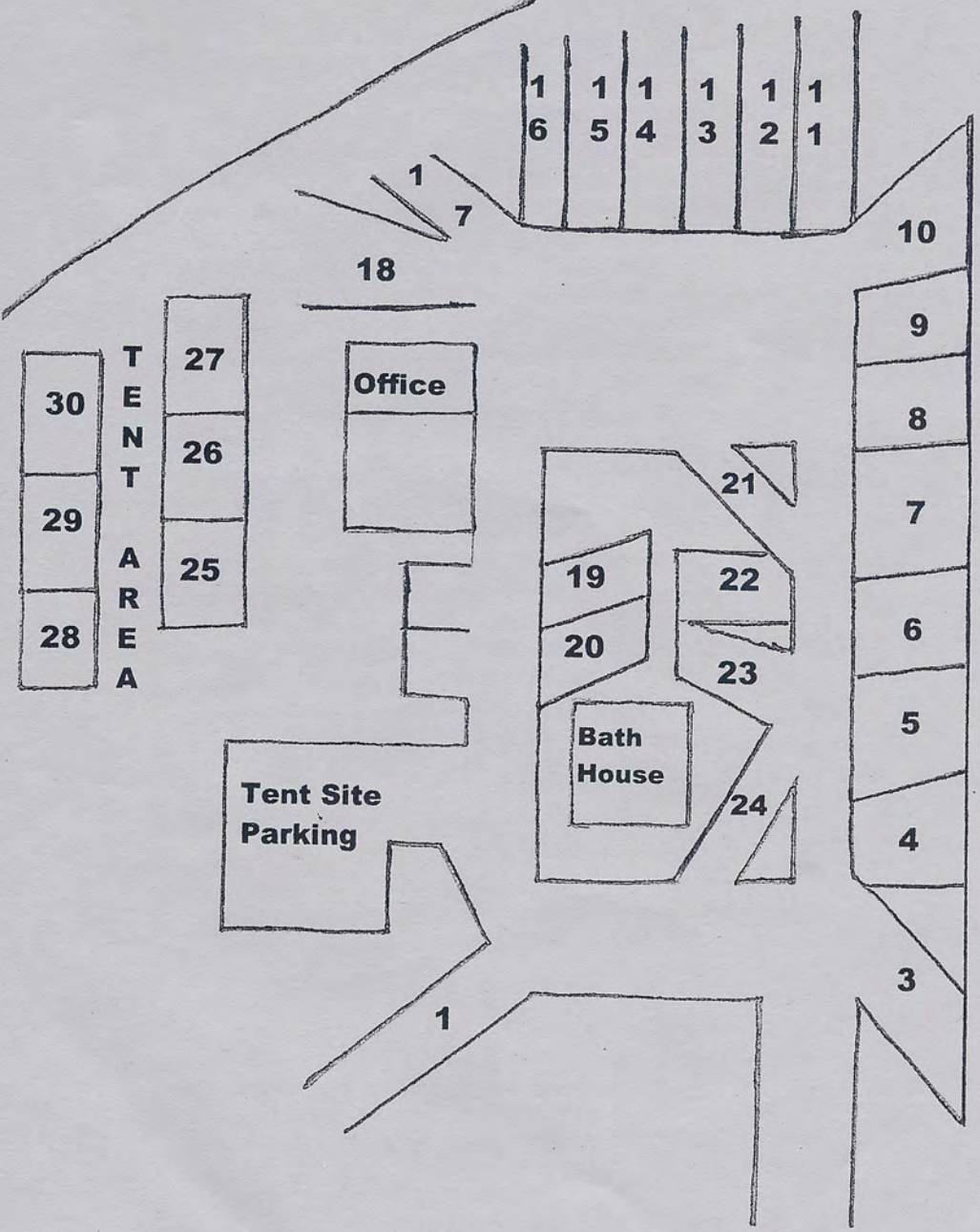

Maryville ← Highway 73 → Smoky Mtns

Welcome to **Ye Olde Mill Campground**.
We hope your stay with us will be a pleasant one.
We offer the following for your safety and camping
convenience.

1. **Speed limit is 5 miles per hour. Watch for children playing.**
2. Check-in time is 2:00 PM. Checkout time is 1:00 PM. Please register by twelve noon if you plan to stay for a longer period of time.
3. Please be considerate of your neighbors. Keep noise at a minimum during quiet hours, 10:00 PM to 7:00 AM. No bike riding in the campground after dark.
4. Alcoholic beverages on your own site, please.
5. Pets are welcome, but must be on a **short** leash at all times. Do not leave the campground and leave pets unattended. Pets are not allowed inside the buildings. Pets must **NOT** disturb your neighbor. Please keep pet litter cleaned up.
6. Please put all garbage, candy wrappers, cans, etc. in a garbage bag, not in the campfire ring. Tie your garbage bag and put it in the dumpster.
7. You are requested to put tents up in designated areas only. Please do not use mats on grass areas any larger than a doormat.
8. Parents are responsible for their children at all times.
9. Visitors are welcome. Please check in at the office on arrival for a car pass. Visitors should leave the campground by 10:00 PM.
10. Use of river is at your own risk.

SPECIFICALLY NOT ALLOWED:

INTOXICATION, PROFANITY, OBSCENITY, ROCK THROWING, USE OF FIREARMS, RIDING OF TWO WHEEL MOTOR VEHICLES (except for entering or exiting campground), AND WASHING OF TRAILER, MOTORHOME, OR CAR.

This is a private property. We reserve the right to enforce all rules for the benefit and safety of all.

Management is not responsible for any loss due to fire, accident, theft, or other conditions beyond our control, and reserves the right to refuse or discontinue service at any time for reasonable cause.

Thank you for your cooperation.

Your Hosts,

Ron and Jackie Suttles